

POWER TRANSMISSION ACCESSORIES

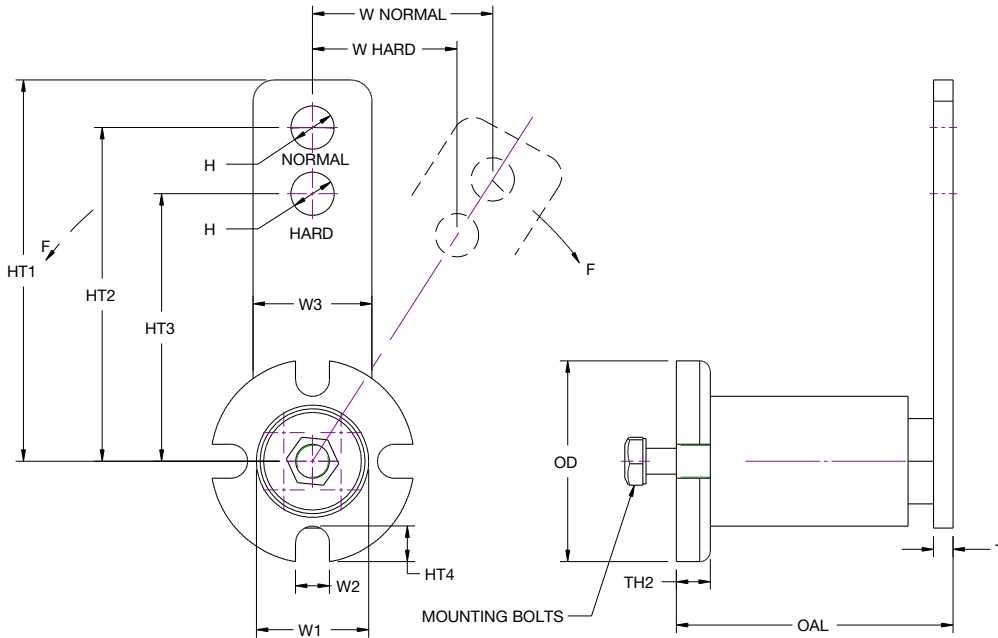

SE TENSIONERS

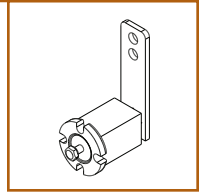

SIZING CHART

ANSI Chain Size	V-Belt Size	Flat Belt Width	Tensioner Model Number
25 S,D,T	A		SE11
35 S,D,T	A,B,3L		SE15
35 S,D,T			
40 S,D,T	B,C,4L,5L	1",2"	SE18
41 S,D,T			
40T, 41T		2"	
50 S,D,T	D,E	3"	SE27
60 S,D,T		4"	
80 S,D,T		4",5"	SE38
80T			
100 S,D,T		5",6"	SE45
120 S,D,T			
160 S,D			
180 S,D			SE45
200 S,D			
160T, 180T			SE50
200T, 240 S,D			

S=SINGLE STRAND
D=DOUBLE STRAND
T=TRIPLE STRAND

Size	H	HT1	HT2	HT3	W3	HT4	W2	W1	L2	L1	OD	TH2	TH1	OAL	Mounting Bolt Size Std SE mm	Drill Hole Size for Std SE Mtg Bolt in	Mounting Bolt Size SE-F mm	Idler Bolt Size in	Weight lbs
SE11	0.39	3.54	3.15	2.36	0.79	0.20	0.31	0.87	N/A	N/A	1.38	0.24	0.20	2.01	M6X20	1/4	N/A	3/8 - 16 X 2	0.66
SE15	0.53	4.43	3.94	3.15	0.98	0.24	0.33	1.18	0.39	0.49	1.77	0.31	0.20	2.52	M8X20	5/16	M6	1/2 - 13 X 2	1.18
SE18	0.53	4.53	3.94	3.15	1.18	0.31	0.33	1.38	0.47	0.74	2.28	0.41	0.28	3.11	M10X30	7/16	M8	1/2 - 13 X 2 1/2	1.80
SE27	0.53	6.1	5.12	3.94	1.97	0.39	0.41	2.05	0.63	0.69	3.07	0.59	0.32	4.25	M12X40	1/2	M10	1/2 - 13 X 3 1/2	4.31
SE38	0.81	8.07	6.89	5.51	2.36	0.47	0.49	2.60	0.75	0.71	3.74	0.59	0.39	5.51	M16X40	5/8	M12	3/4 - 10 X 5	8.71
SE45	0.81	10.24	8.86	7.09	2.76	0.47	0.49	3.15	1.06	1.30	4.53	0.71	0.47	7.87	M20X50	13/16	M20	3/4 - 10 X 6	16.06
SE50	0.81	11.42	9.84	7.87	3.15	0.67	0.67	3.07	1.10	0.91	5.12	0.79	0.79	8.27	M24X60	1	M20	3/4 - 10 X 6	25.14